



CITY OF LAWTON
COMMUNITY SERVICES DEPARTMENT
PLANNING DIVISION

212 SW 9th Street, Lawton, Oklahoma 73501
Phone (580) 581-3375 • Fax (580) 581-3573 • www.lawtonok.gov

August 31, 2020

**NOTICE OF PUBLIC HEARING ON A VARIANCE TO
THE 20 FOOT REAR YARD SETBACK**

This is to notify you that on Friday, September 11, 2020, at 9:00 a.m., in the Auditorium of City Hall, 212 SW 9th Street, Lawton, Oklahoma, the Board of Adjustment will review the request submitted by Cynthia Riddle, for a variance to Section 18-5-3-523.A, Lawton City Code, 2015, to vary the 20 foot rear yard setback requirement in an R-1 Single-Family Dwelling District on property located at 4805 NE Winfield Circle as shown on the maps filed in the office of the Planning Division and described as follows:

Lot 31, Block 4, MacArthur Park Addition, Part 4

The above-described property is located at 4805 NE Winfield Circle. The attached map indicates the area involved in the request. Your property is within 300 feet of the requested variance.

Cynthia Riddle has built an addition to her single-family dwelling in the rear yard that is located within the required rear yard setback.

If you desire to make a statement for or against said variance, you are invited to appear in person, by petition, or by attorney to so state your position to the Board of Adjustment on the above date. If you have any questions, please contact the Planning Division at (580) 581-3375.



TRACI HUSHBECK, CITY CLERK

Attachment - Location Map

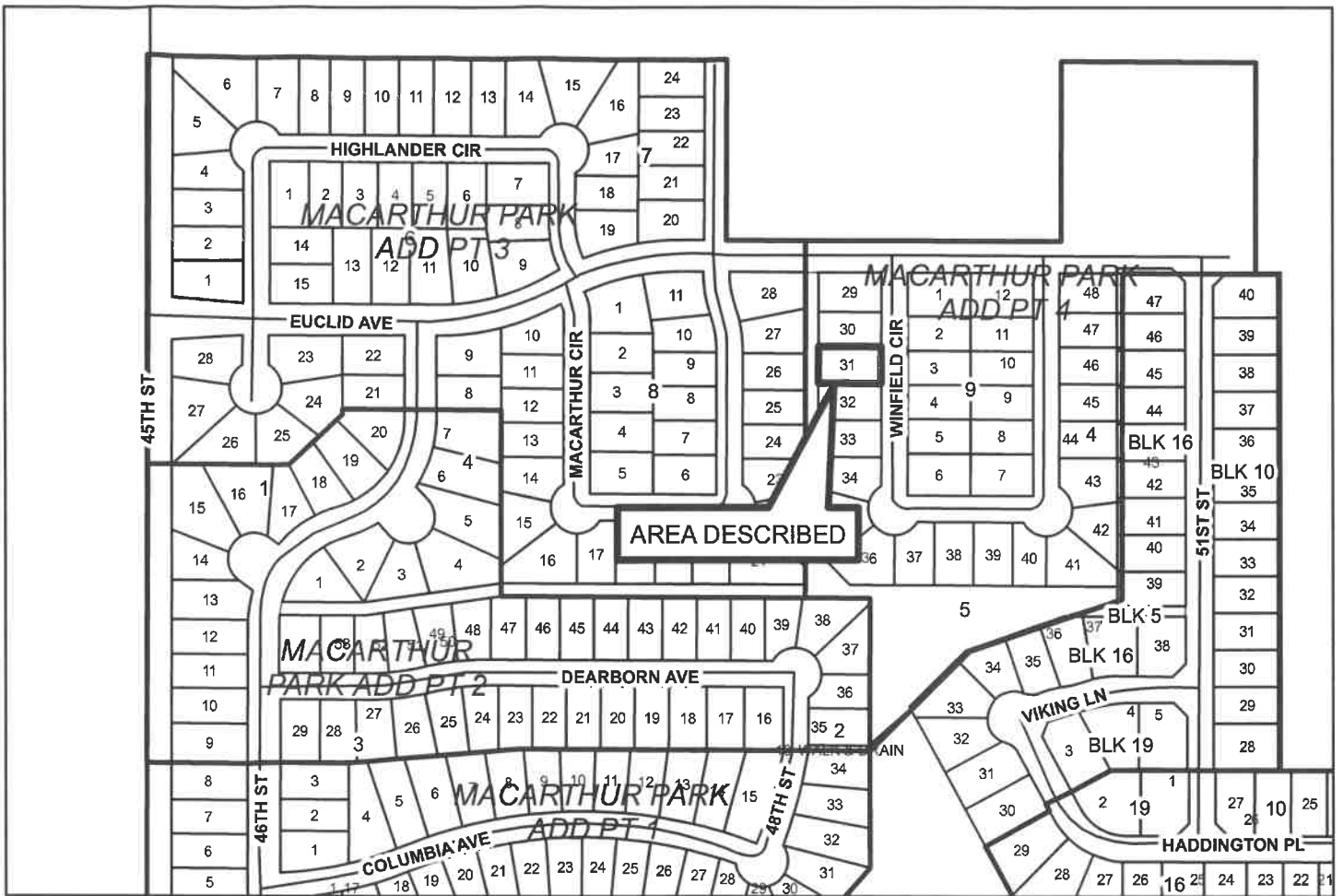

REQUEST FOR BOARD OF ADJUSTMENTS

VARIANCE REQUESTED: Rear yard setback.

REQUESTED BY: Cynthia Riddle

AREA DESCRIBED AS:

Lot 31, Block 4, MacArthur Park Addition, Part 4,
to the City of Lawton, Comanche County, Oklahoma

Legend

-  Area Described
-  300' Area

